

DOUBLE GLAZED

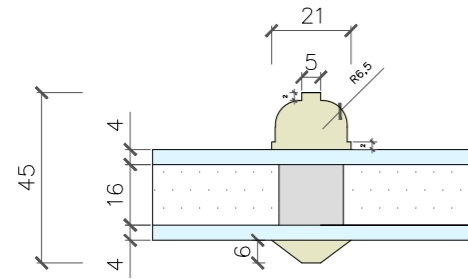

21/5 Bonded Glazing Bar 6.5mm radius
Ovolo with Putty Profile Chamfered Bead

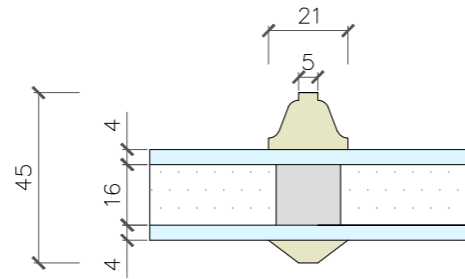

21/5 Lambs (Sash requires 49mm to be fensa spec)

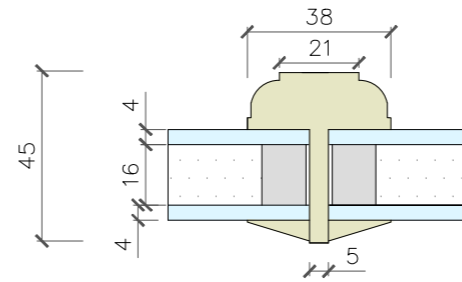

38/9 Ovolo Glazing Bar

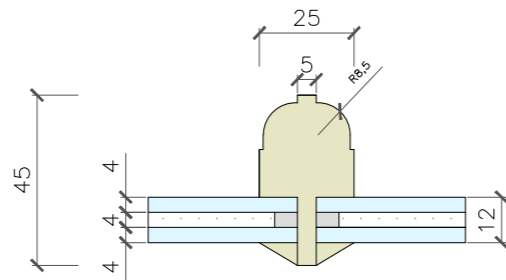

25/5 8.5mm radius Ovolo – Listed building spec

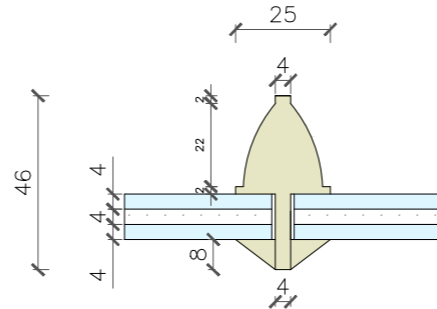

25/4 Glazing Bar

SINGLE GLAZED

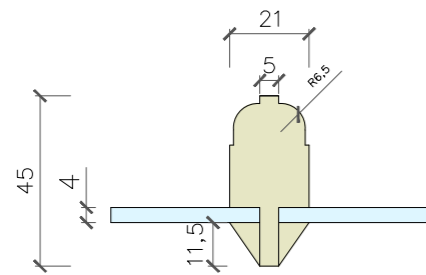

21/5 6.5mm radius Ovolo

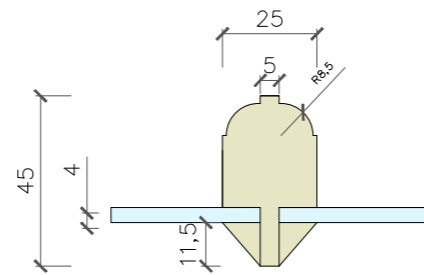

25/5 8.5mm radius Ovolo

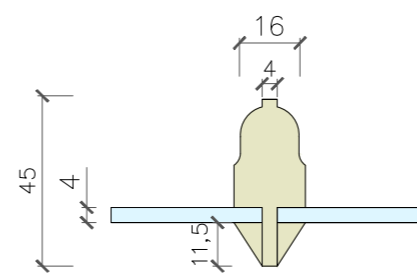

16/4 Lambs Tongue



Tel: 020 8017 1632
info@londonsash.com
The London Sash Window Company
41 High Street, London SE20 7HJ

DO NOT SCALE THIS DRAWING. USE FIGURE DIMENSIONS

NOTES:

CLIENT:	The London Sash Window Company
LOCATION:	N/A
SCALE:	Scale 1:2 @A3
DRAWN BY:	TB
DATE	19 November 2019
DRAWING TITLE:	Glazing bars detail
DRAWING NUMBER:	1
QUANTITY:	N/A
REVISION:	N/A